

**CAOS** TERMOPARETI®

**PANELS**  
**elcom system**  
ITALY

Out of the schemes,  
new interpretation of space...

new

TERMOPARETI®  
**CAOS** is here!

*A new frontier of material*

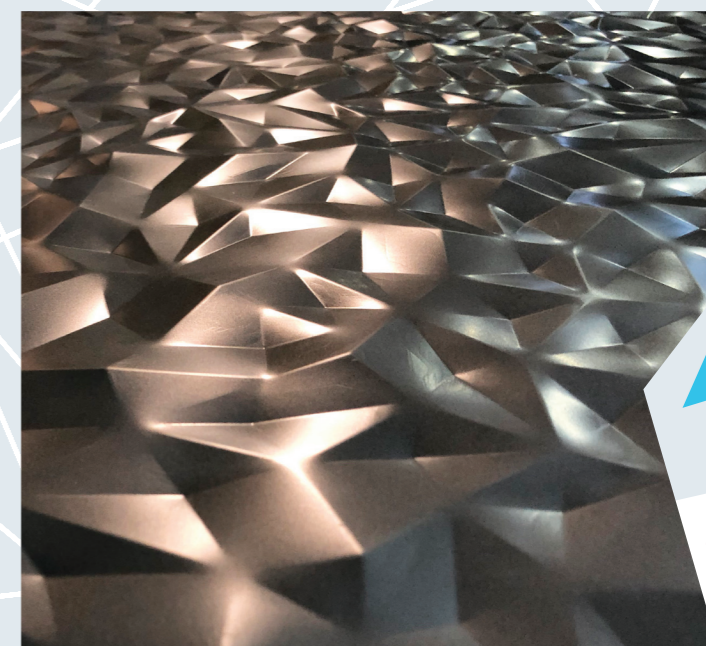

## Material comes to life

**CAOS, the unexpected panel**, far from the common idea that has characterized this key element of prefabrication. Design, surface, material, finishing and colours break the standard patterns offering innovative and exciting solutions more than ever before.

The choice of this name, **CAOS**, introduces the idea of changing the order of things; it's an element designed to move, to animate, to create, to modify space with a surprising originality.

**CAOS** is an ambitious project with a revolutionary concept, both aesthetic and architectural, being brand new in inspiration and design.

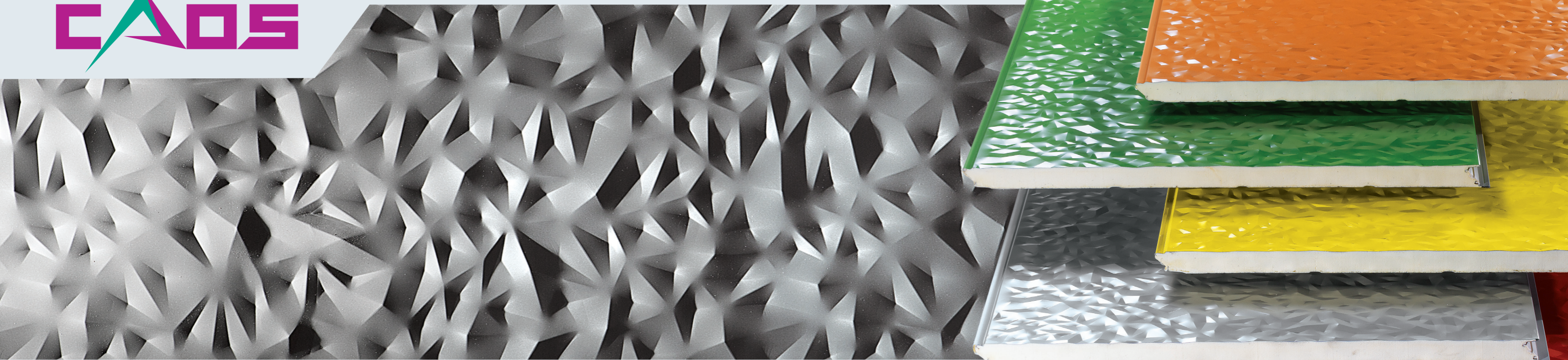

An ambitious,  
revolutionary project.

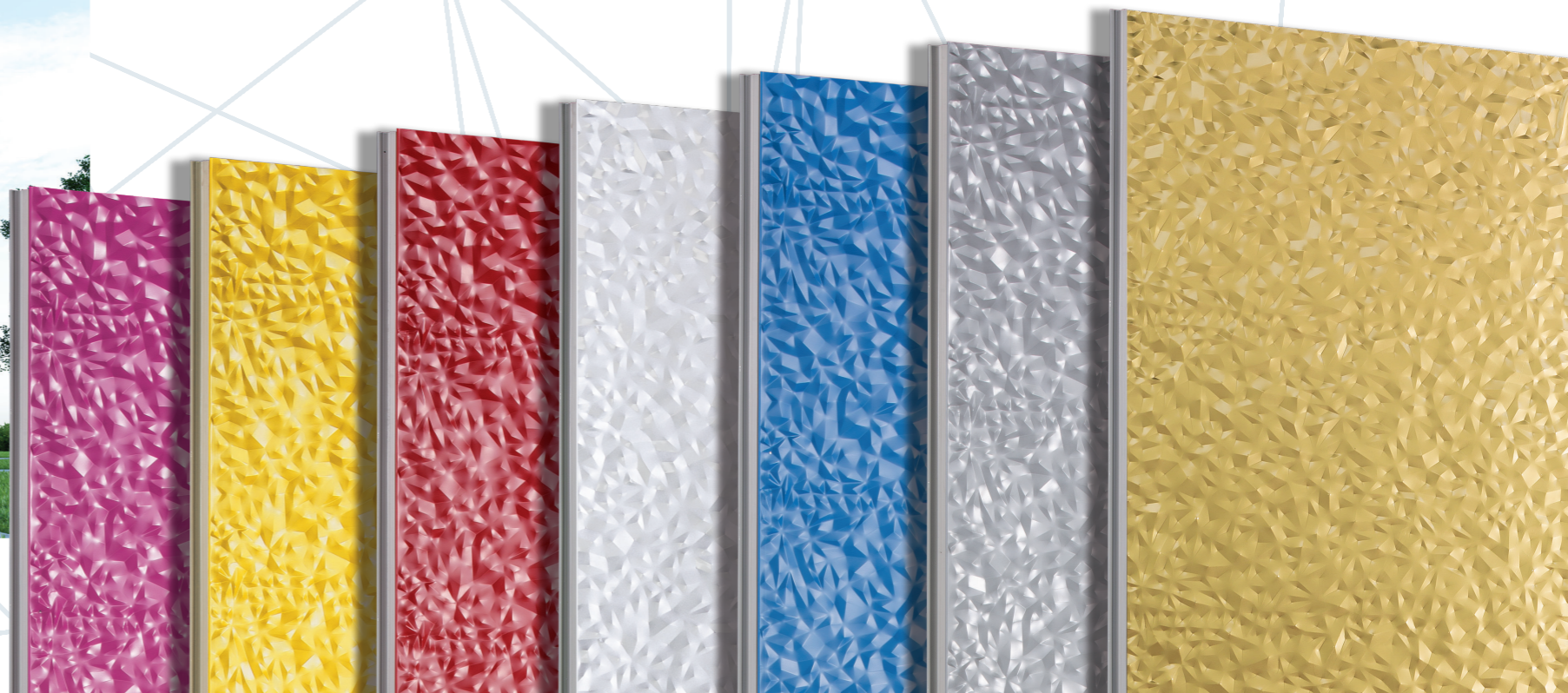

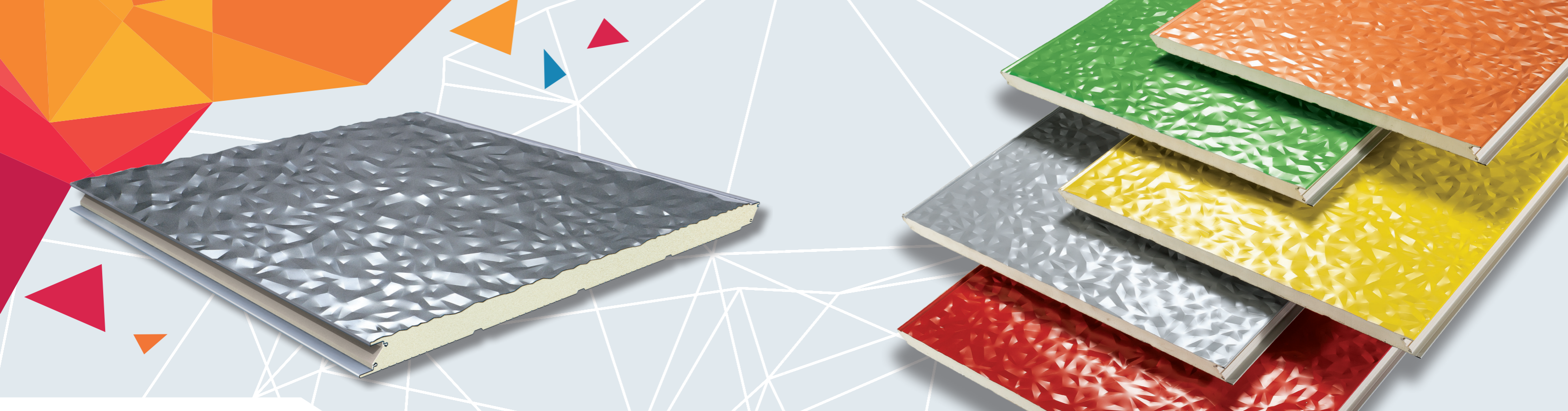

# TERMOPARETI® CAOS

## Technical characteristics and performances:

**Supports:** **STEEL** - S 250 GD according UNI EN 10346 norm, mechanical characteristics as D.M. of 14/01/2008 and tolerances according UNI EN 10143 Norm  
**ALUMINIUM** - UNI EN 1396 with 150 Mpa minimum yielding limit  
**COPPER** - UNI EN 1172; **COR-TEN**  
**STAINLESS STEEL** - according UNI EN 10088-1 Norm

**Insulation:** PUR Density ~ 40 Kg/m<sup>3</sup>  
**Thickness:** 40-50-60-80-100 mm  
**Standard panel width:** 1000 mm

The panels **TERMOPARETI® CAOS (patented)** have been studied to create original architectural impressions and can be used in industrial, commercial, residential building and public utilities, for new buildings and renovations. The **CAOS** panels can be used for continuous and/or discontinuous external walls, internal partitions and ceilings, on any type of structure such as metallic, concrete and wood, and their installation can be vertical, horizontal or inclined. The panels have a joint and they are fixed with specific accessories. The peculiarity of the panels **CAOS** is on the external side: particular and different geometric shapes obtained from an innovative and unique system specifically developed by ELCOM SYSTEM S.p.A. to form the external surface, reaching an extremely dynamic effect never seen before on the market of metallic insulated panels. The imprints are positive respective the external side of the support and they can be realised on different materials such as galvanized and/or prepainted steel, aluminium, stainless steel and copper. Elements with thermic cut such as rounded and right corners, edges and spherical connections are used to complete and improve more and more the **TERMOPARETI® CAOS**.

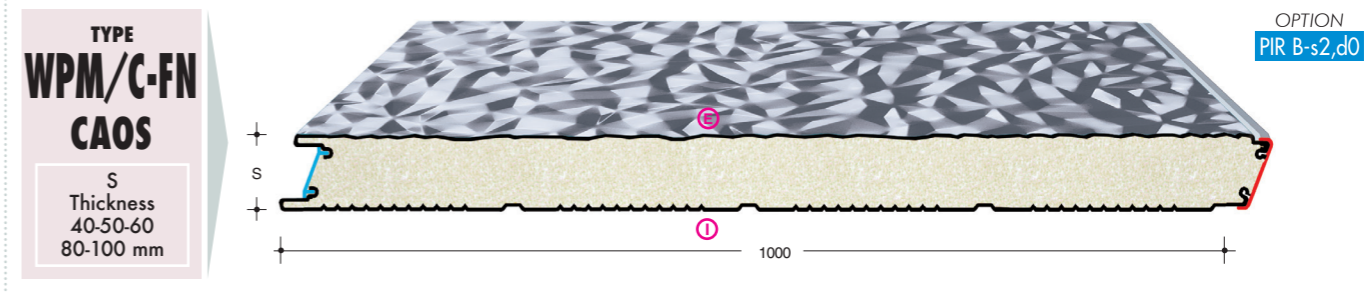

SUPPORT CONDITIONS					Useful loads uniformly distributed in KG/m <sup>2</sup> – KN/m <sup>2</sup>									
S thickness mm	U		weight Kg/m <sup>2</sup>	U.M.	SPAN IN ℓ m									
	Kcal m <sup>2</sup> ·h·°C	W m <sup>2</sup> ·°C			2,00	2,50	3,00	3,50	4,00	2,00	2,50	3,00	3,50	4,00
40	0,461	0,536	10,15	Kg/m <sup>2</sup> KN/m <sup>2</sup>	166 1,63	125 1,22	90 0,88	70 0,68	55 0,54	178 1,74	140 1,37	108 1,05	85 0,83	70 0,68
50	0,372	0,433	10,53	Kg/m <sup>2</sup> KN/m <sup>2</sup>	225 2,21	160 1,57	120 1,18	90 0,88	70 0,68	245 2,41	182 1,78	140 1,37	115 1,13	90 0,88
60	0,313	0,364	10,91	Kg/m <sup>2</sup> KN/m <sup>2</sup>	289 2,83	216 2,12	142 1,39	115 1,13	85 0,83	321 3,15	237 2,32	181 1,77	141 1,38	115 1,13
80	0,237	0,276	11,67	Kg/m <sup>2</sup> KN/m <sup>2</sup>	455 4,46	316 3,09	227 2,22	160 1,57	120 1,18	500 4,91	365 3,58	280 2,74	215 2,11	145 1,42
100	0,191	0,222	12,63	Kg/m <sup>2</sup> KN/m <sup>2</sup>	470 4,60	345 3,38	260 2,55	200 1,96	160 1,57	510 4,99	390 3,82	285 2,79	225 2,20	180 1,76

**LOAD CONDITIONS WITH STEEL SUPPORTS:**  
 The values shown in the tables are indicative and referred to a deflection  $f \leq 1/200$  of the span  $\ell$  (m) for panels with thickness of **STEEL** supports 0,5+0,5 mm.  
 For sizing and checking refer to the enclosed E of the UNI EN 14509 Norm and to the values shown in the CE certification. The letter  $\text{Ⓢ}$  shows the required painted side.

SUPPORT CONDITIONS					Useful loads uniformly distributed in KG/m <sup>2</sup> – KN/m <sup>2</sup>									
S thickness mm	U		weight Kg/m <sup>2</sup>	U.M.	SPAN IN ℓ m									
	Kcal m <sup>2</sup> ·h·°C	W m <sup>2</sup> ·°C			2,00	2,50	3,00	3,50	4,00	2,00	2,50	3,00	3,50	4,00
40	0,461	0,536	5,16	Kg/m <sup>2</sup> KN/m <sup>2</sup>	108 1,06	64 0,62	41 0,40	27 0,26	19 0,18	149 1,46	95 0,93	64 0,63	44 0,43	32 0,31
50	0,372	0,433	5,56	Kg/m <sup>2</sup> KN/m <sup>2</sup>	150 1,47	92 0,90	60 0,58	41 0,40	29 0,28	194 1,90	129 1,26	89 0,87	63 0,61	46 0,45
60	0,313	0,364	5,96	Kg/m <sup>2</sup> KN/m <sup>2</sup>	191 1,87	121 1,18	81 0,79	56 0,55	40 0,39	237 2,32	162 1,59	114 1,11	83 0,81	62 0,61
80	0,237	0,276	6,76	Kg/m <sup>2</sup> KN/m <sup>2</sup>	272 2,67	180 1,76	125 1,22	89 0,87	65 0,63	317 3,11	225 2,20	165 1,62	124 1,21	95 0,93
100	0,191	0,222	7,56	Kg/m <sup>2</sup> KN/m <sup>2</sup>	290 2,84	235 2,30	180 1,76	110 1,08	90 0,88	310 2,94	255 2,49	190 1,86	135 1,32	100 0,98

**LOAD CONDITIONS WITH ALUMINIUM SUPPORTS:**  
 The values shown in the tables are indicative and referred to a deflection  $f \leq 1/200$  of the span  $\ell$  (m) for panels with thickness of **ALUMINIUM** supports 0,6+0,6 mm.  
 For sizing and checking refer to the enclosed E of the UNI EN 14509 Norm and to the values shown in the CE certification. The letter  $\text{Ⓢ}$  shows the required painted side.

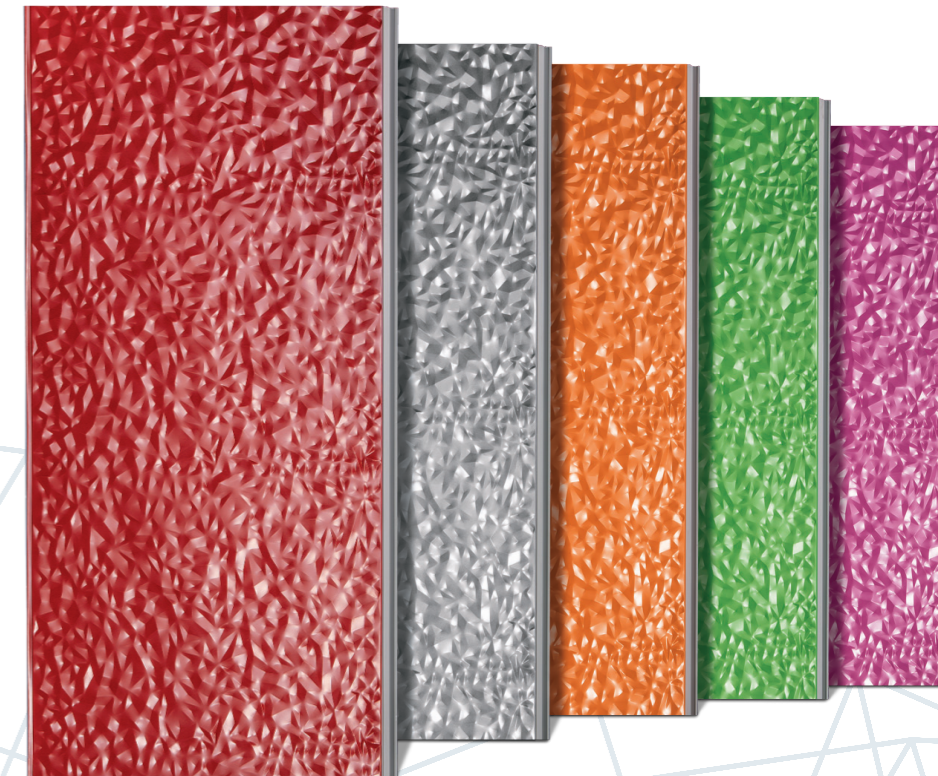
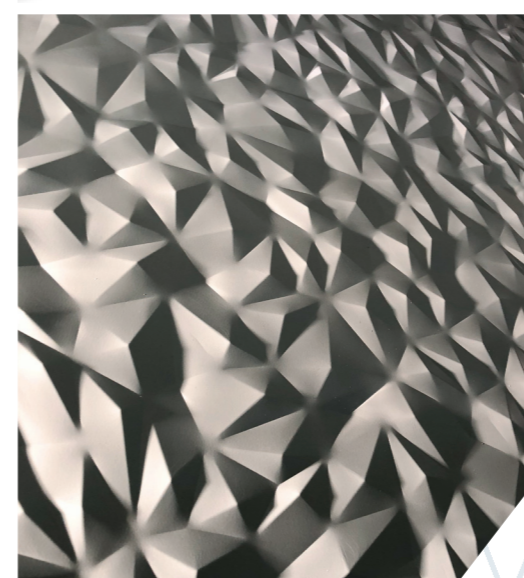
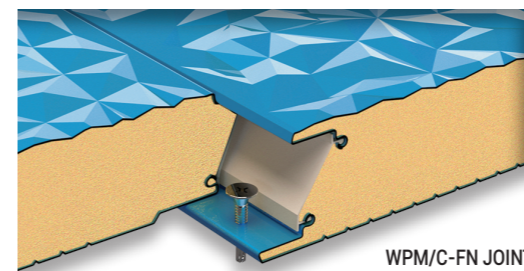

The new  
frontier  
of panels.

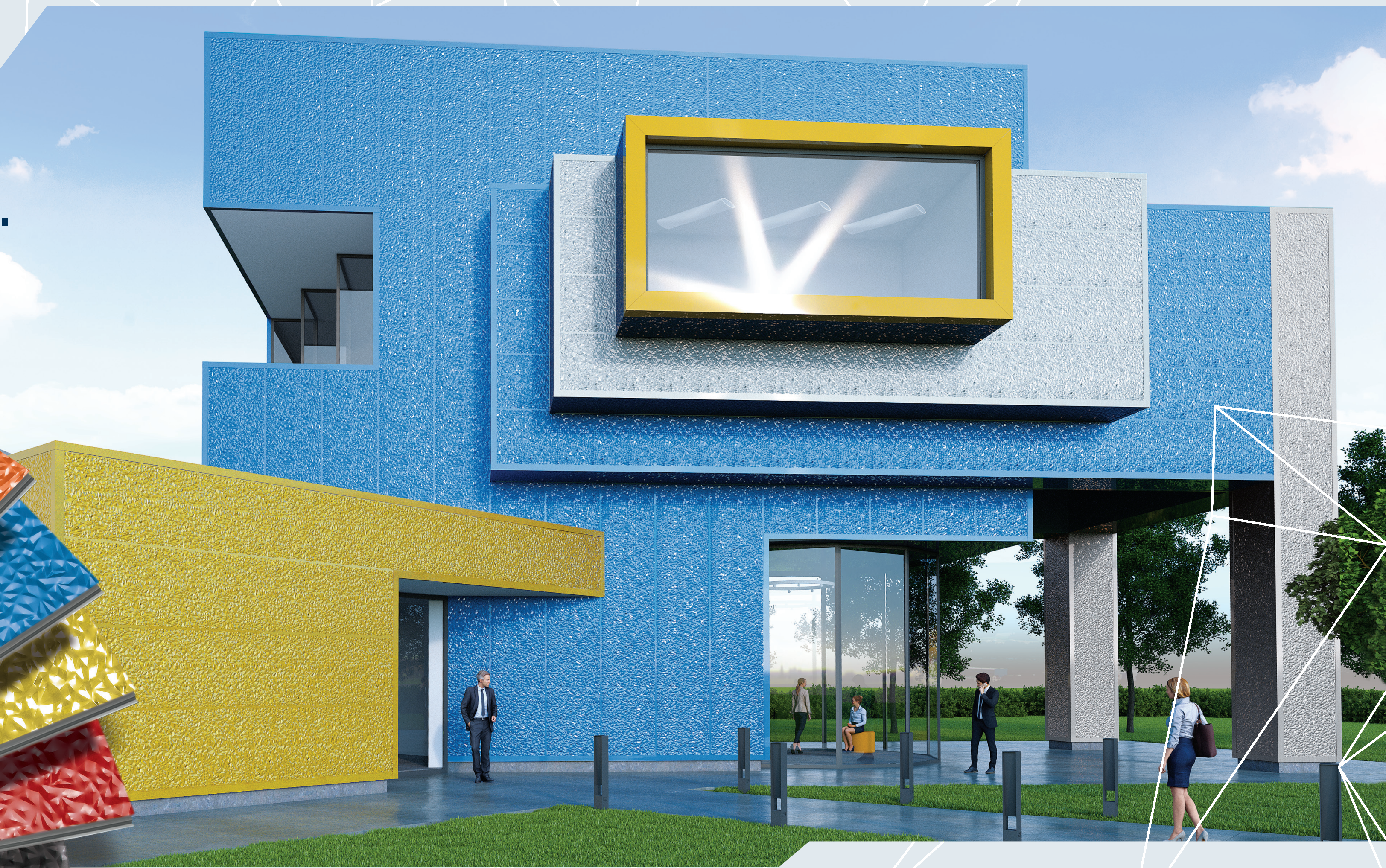
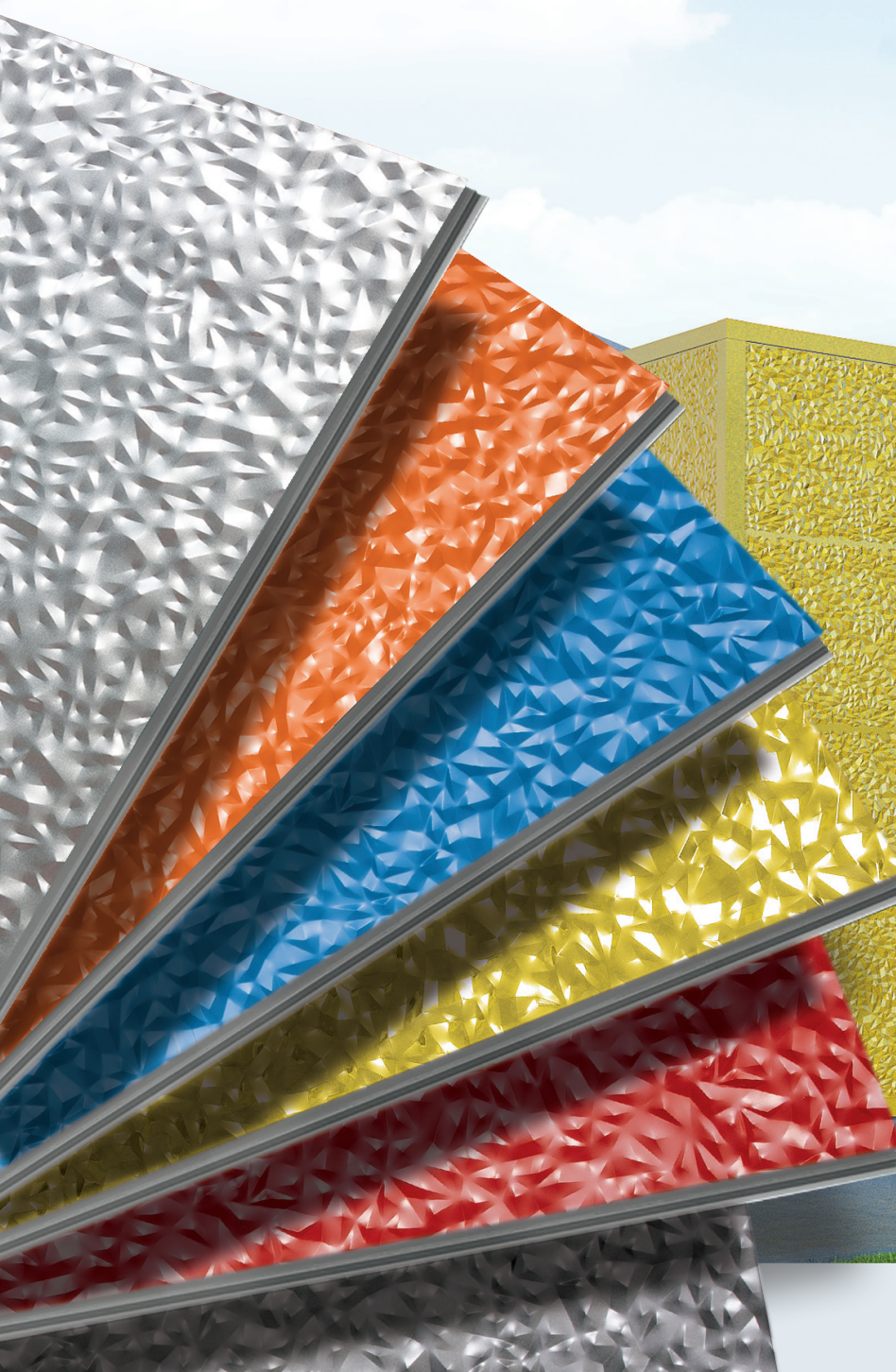

A new age  
has come:  
**CAOS**  
the brand new  
panel!

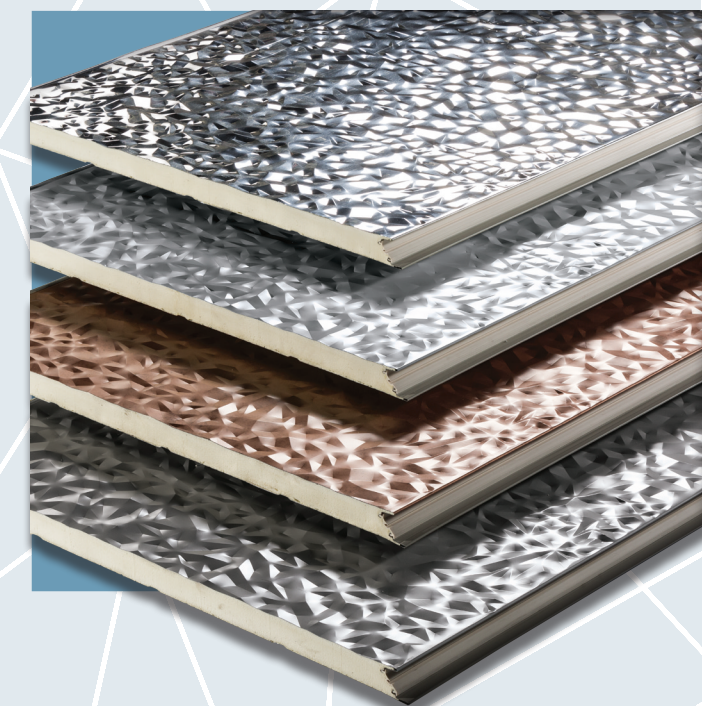



## Internal partitions

CAOS is...  
Creativity  
Art  
Originality  
Shape

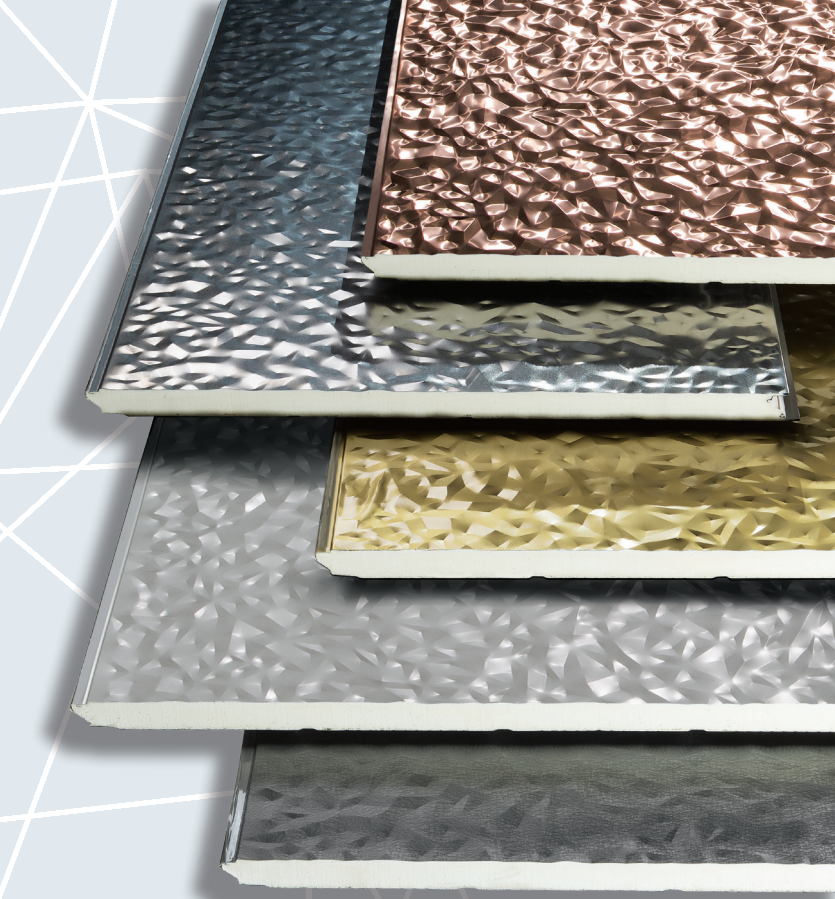
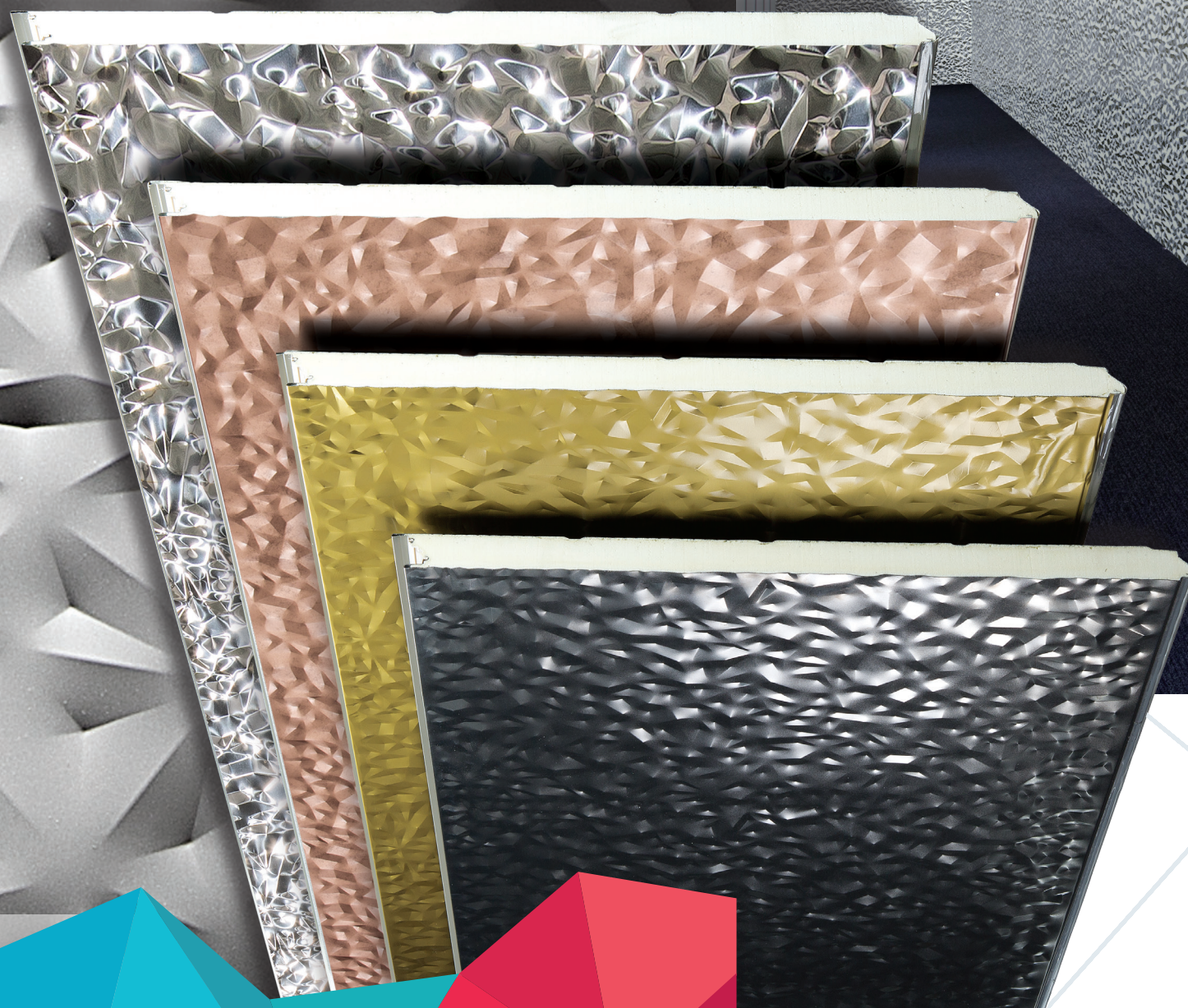

A revolutionary  
irregular texture....  
rising CAOS!

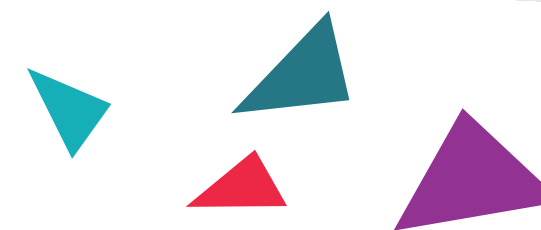

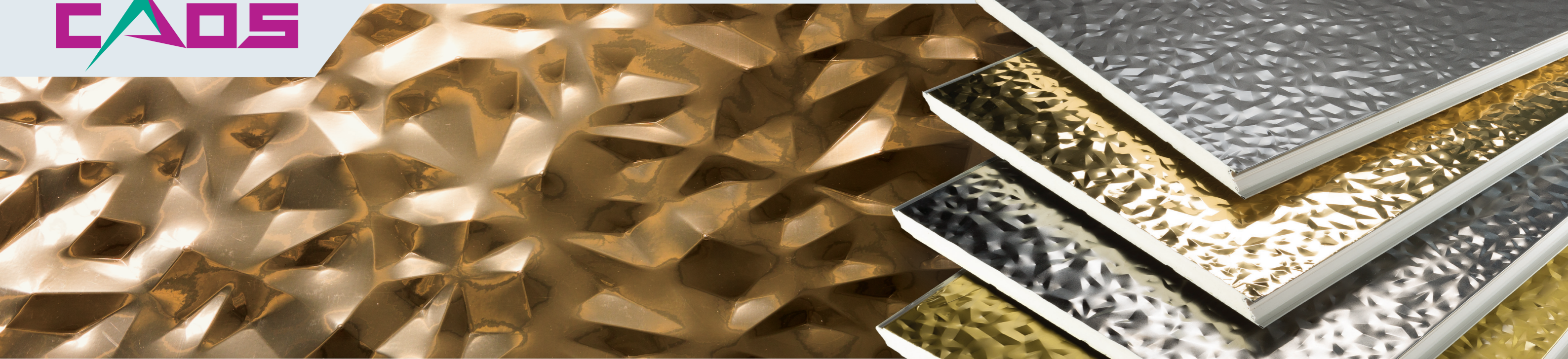

An innovative design  
for a new interpretation of space

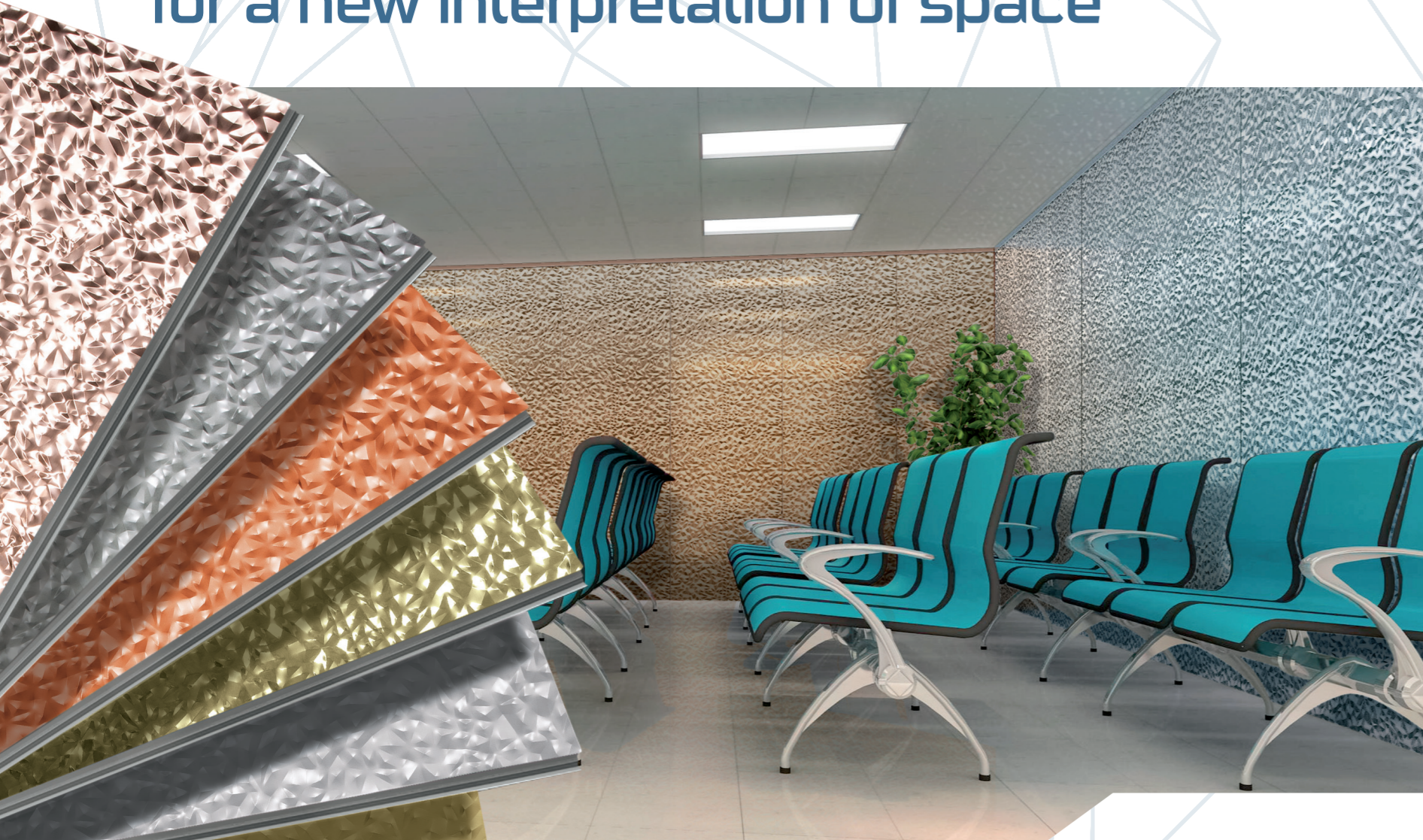

Systems for architectural wall claddings  
Special components with thermic cut

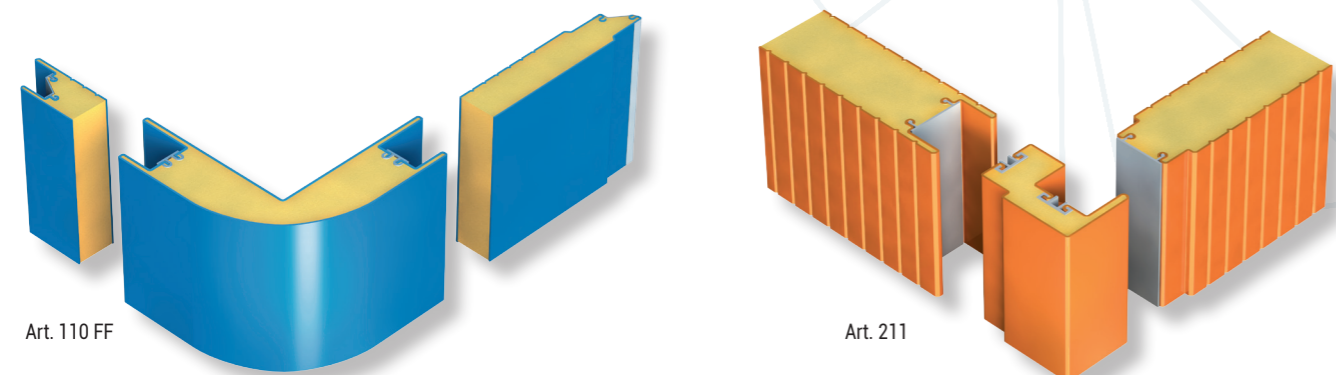
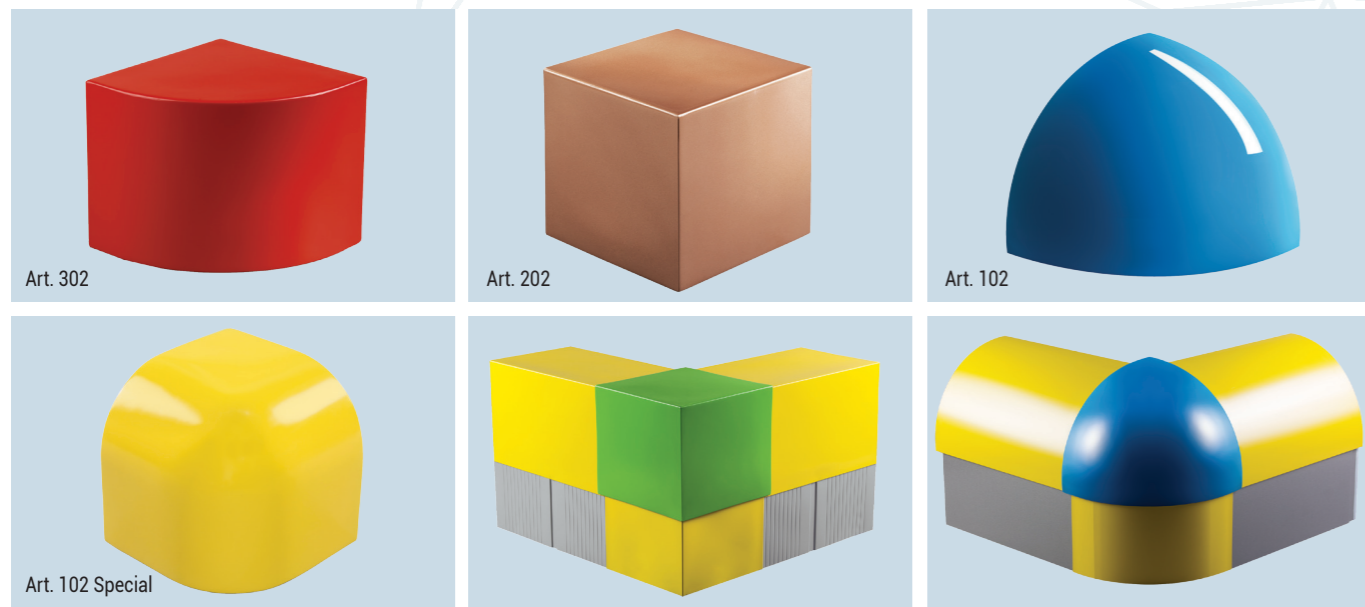
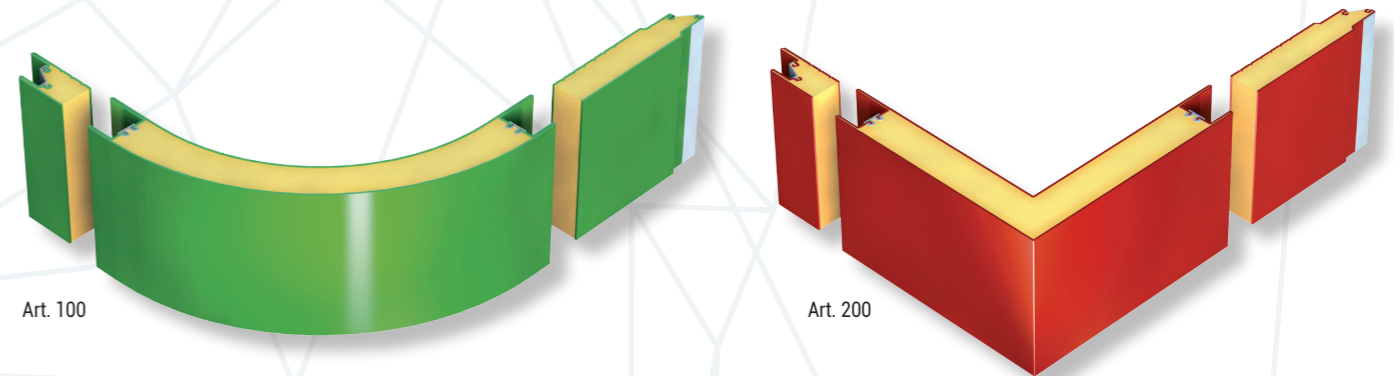
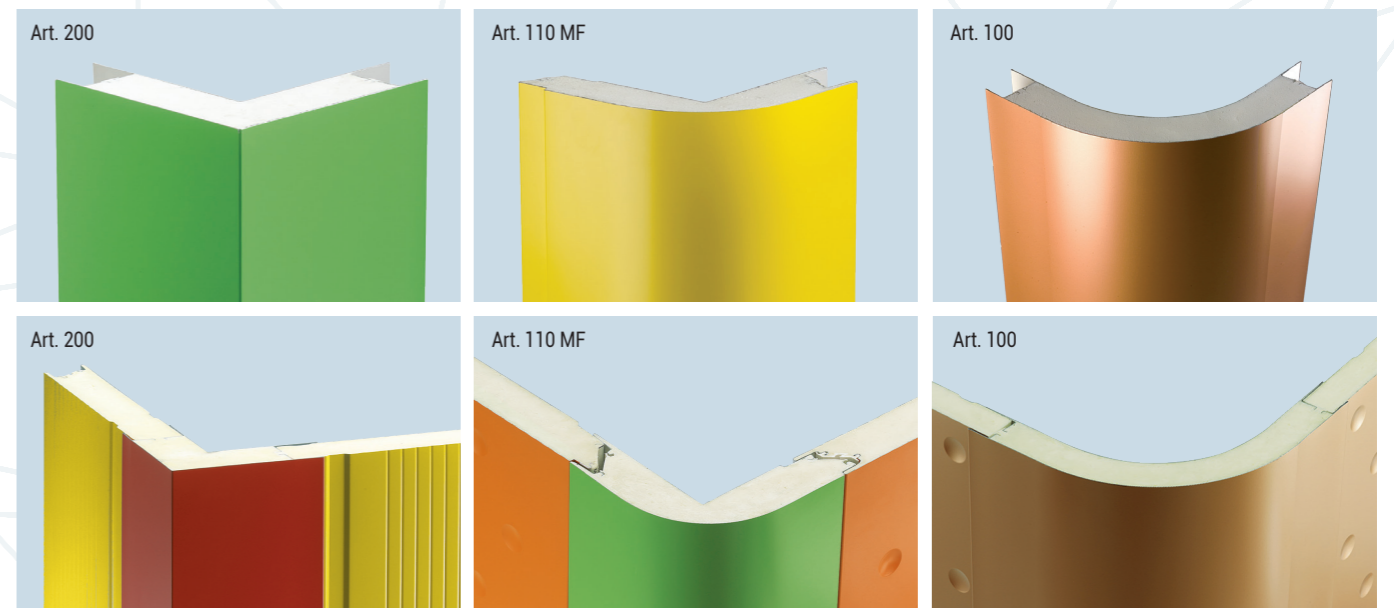
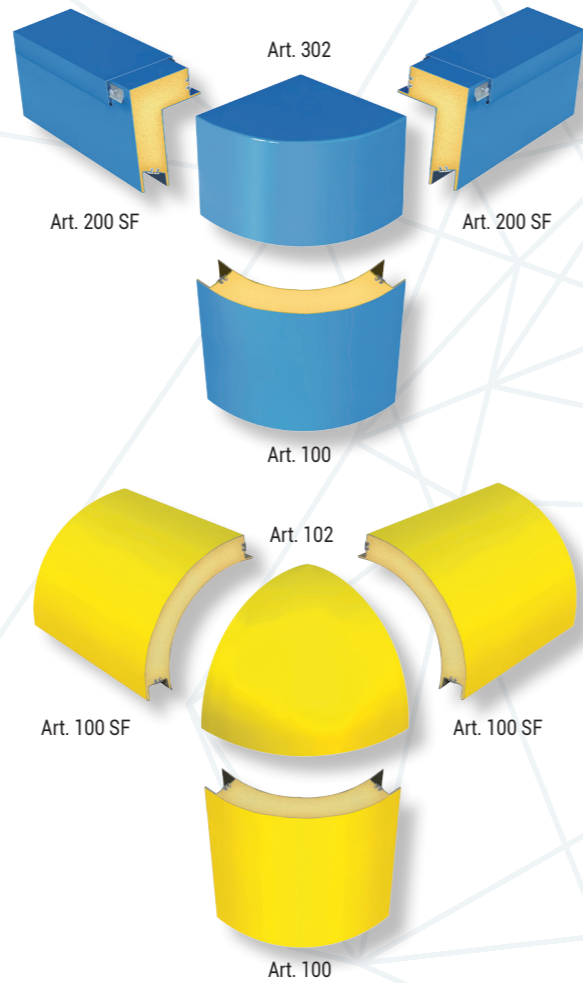
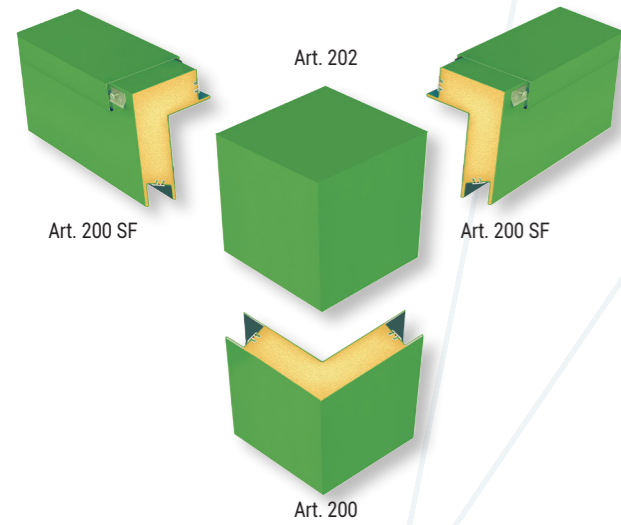



# GEOMETRIES



## Surprising Solutions creating Architecture.



06059 PANTALLA di TODI (PERUGIA) Italy  
Tel. +39.075.8855 - info@elcomsystem.it

[elcomsystem.it](http://elcomsystem.it)

[facciatearchitetoniche.it](http://facciatearchitetoniche.it)

